

# ASSEMBLY INSTRUCTIONS FOR THE #5285-01 INSTRUMENT CART



top shelf



doors with lock

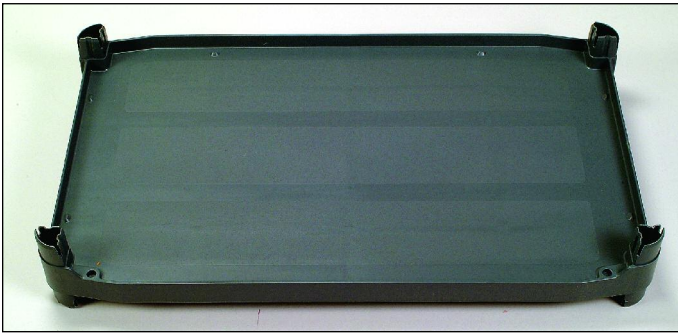

bottom shelf



middle shelf

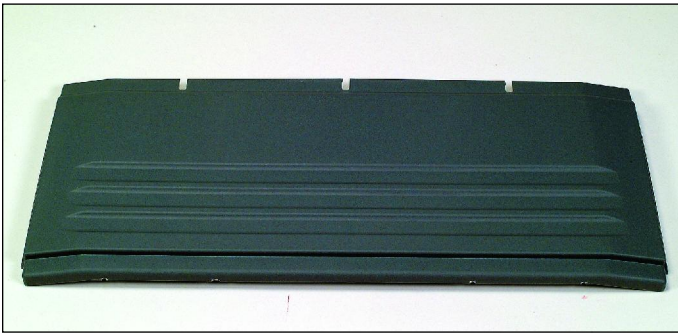

back cover panel

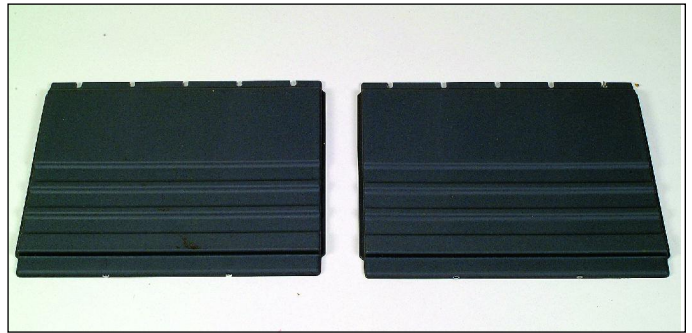

side cover panels



storage drawer

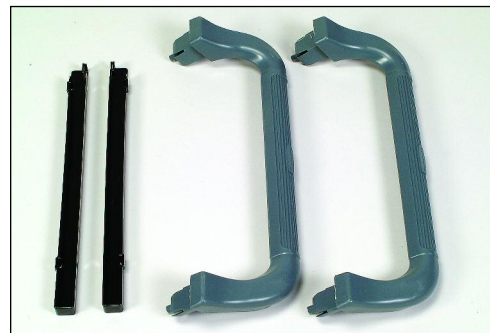

handles and drawer slides



# ASSEMBLY INSTRUCTIONS FOR THE #5285-01 INSTRUMENT CART

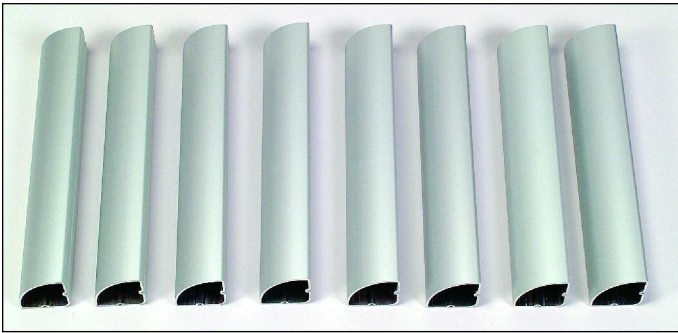

shelf posts

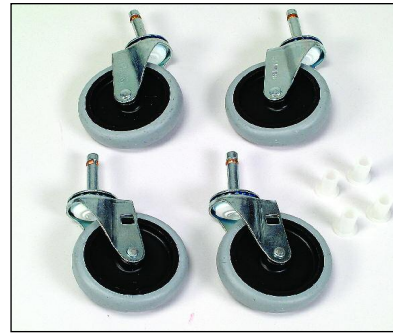

4 casters

## LOCK INSTALLATION INSTRUCTIONS

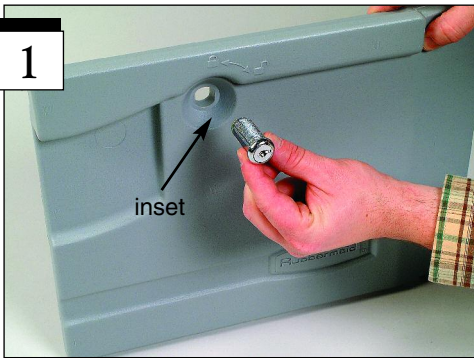

**1**  
Locate your right door with lock hole. Insert the lock through the hole until the face of the lock is flush with the door inset. The keyhole should be positioned up and down.



**2**  
Once your lock is in the door flip your door so you're looking at the backside.



**3**  
Thread on the nut (turn clockwise) included with the lock to secure the lock in the door.



**4**  
Locate the bronze cam and attach it to the end of the lock so it is pointing straight up. The square cutout in the cam will slide over the square end of the lock.

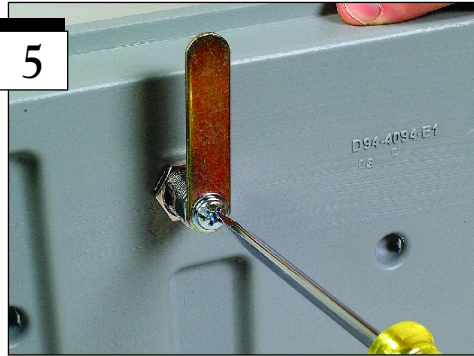

**5**  
Secure the cam to the lock with the screw provided. Tighten with a Phillips screwdriver.



**6**  
Your lock is now attached and your doors are ready to be installed later in the assembly process.

# ASSEMBLY INSTRUCTIONS FOR THE #5285-01 INSTRUMENT CART

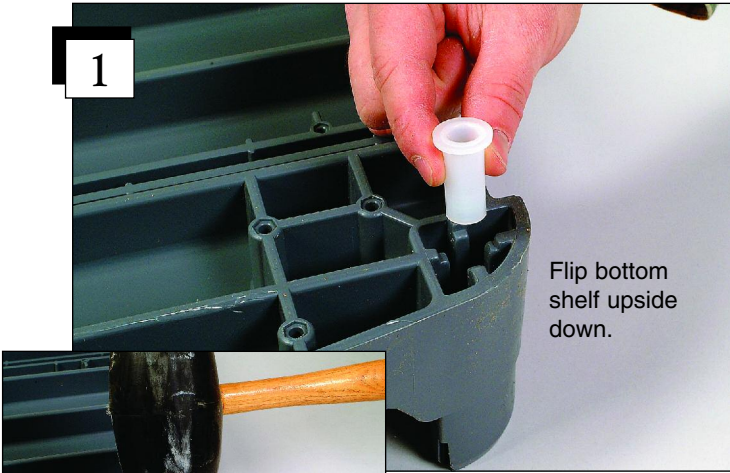

1

Flip bottom shelf upside down.

For the first step you will need the bottom shelf. The bottom shelf has an area on all four corners for caster inserts. Press a caster insert into one of the corners and tap down with a rubber mallet. Repeat for all corners.



2

Once inserts are in you can attach casters. Press a caster into one of the inserts and tap down with your rubber mallet. Repeat for remaining casters.



3

Attach the remaining casters and you're ready to flip over and continue assembly.

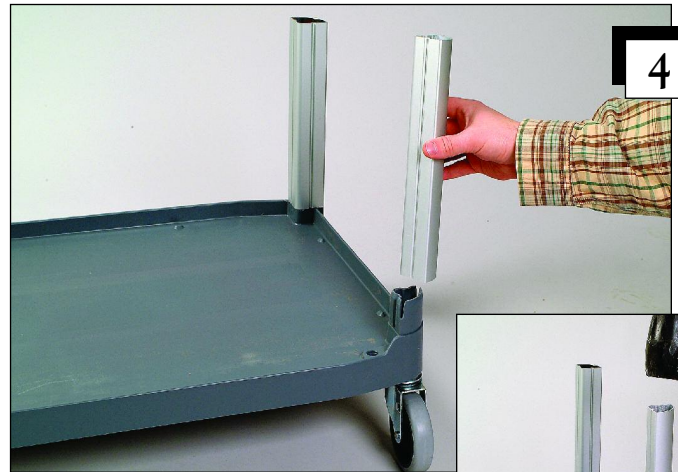

4

Insert a post in each corner of the bottom shelf. You will need to tap posts down with your rubber mallet.

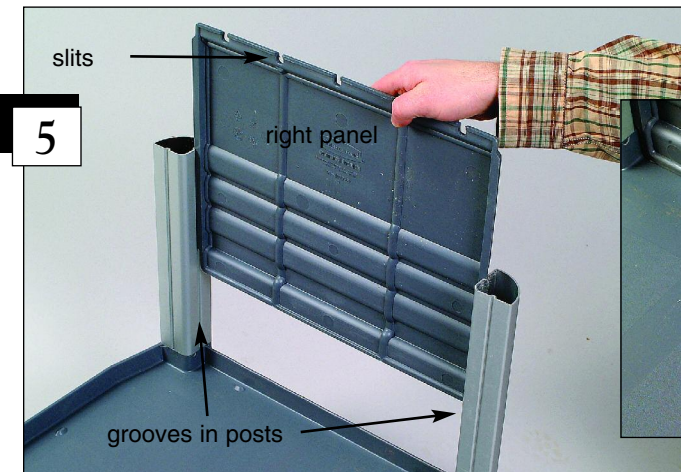
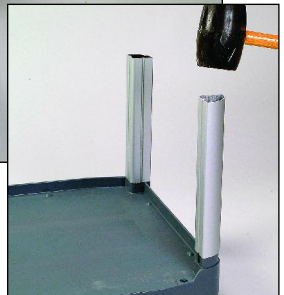

5

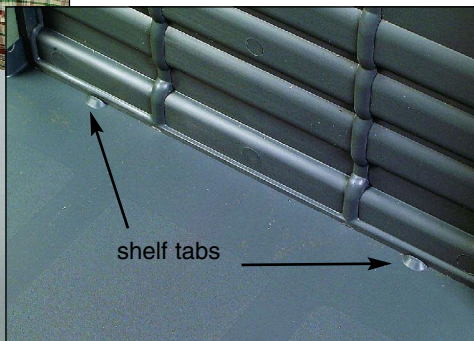

The bottom of the panel should slide in front of the shelf tabs.

Attach the side closure panels by sliding into the grooves in between two shelf posts. The slits on the panels should be facing up.

# ASSEMBLY INSTRUCTIONS FOR THE #5285-01 INSTRUMENT CART



Once the side panels are installed, attach the back closure panel by sliding into the grooves in between two shelf posts. The slits on the panels should be facing up.

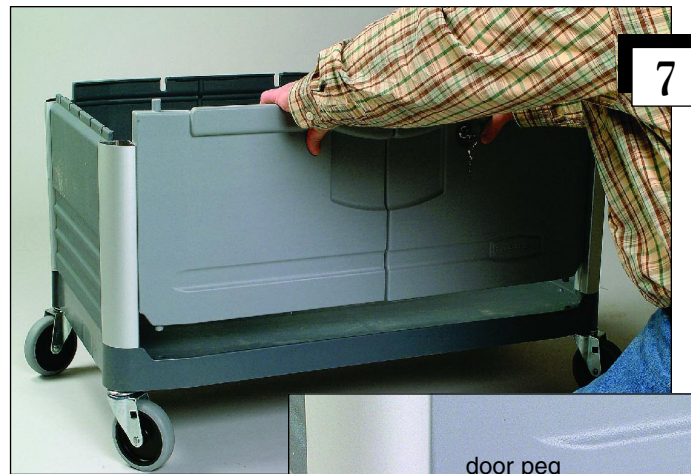

With the doors interlocked slide into the grooves in between two shelf posts on the front of the cart. The pegs on the doors should align with the holes in the bottom shelf.

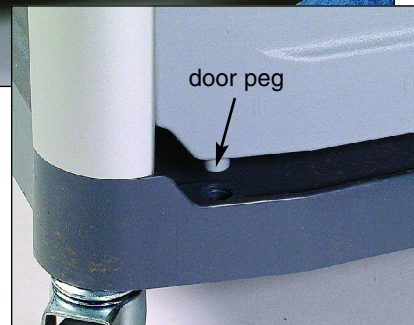

You're now ready to attach the middle shelf. Position the middle shelf so the corners slide into the shelf posts. The shelf ledge should be at the back of the cart.

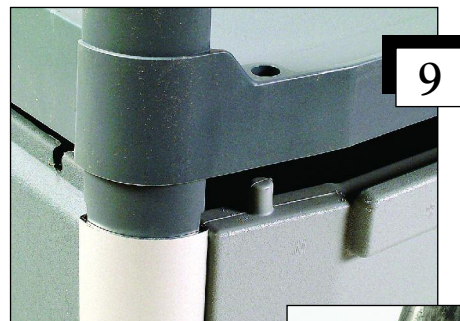

The holes in the front of the middle shelf will slide over the pegs in the top of the doors. Tap the shelf into the posts using your rubber mallet.



Attach a post in each corner of the middle shelf. Tap down with your rubber mallet.

Your small friend, indeed®  
**Health Care Logistics** INC. 

# ASSEMBLY INSTRUCTIONS FOR THE #5285-01 INSTRUMENT CART

11



Your cart comes with a drawer and drawer slides. The slides attach to the bottom of the top shelf as shown above.

12



Slides are marked left and right. Position the right slide to the holes on the underside of the top shelf. The slide should be positioned with the open side facing in.

13

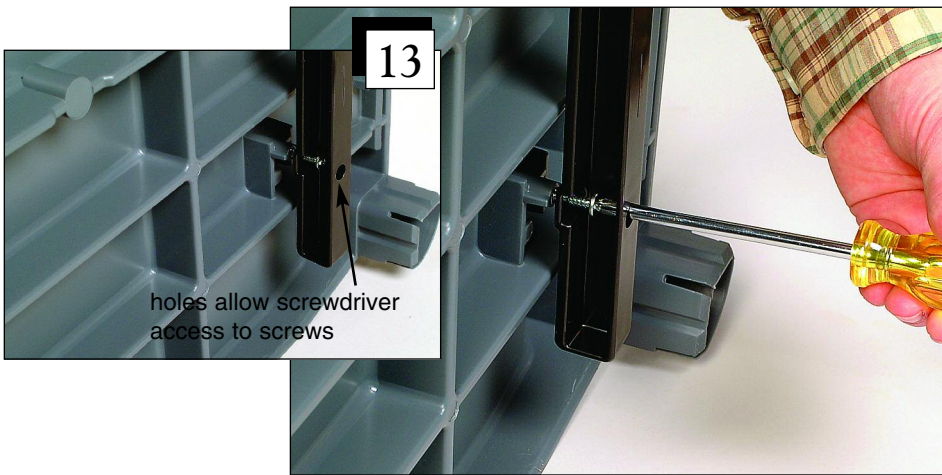

Using your Phillips screwdriver and hardware provided with slides, attach slides to the bottom of the shelf. The slides have holes that allow the screwdriver to pass through to tighten screws.

14



The top shelf will look like this when slides are attached.



# ASSEMBLY INSTRUCTIONS FOR THE #5285-01 INSTRUMENT CART

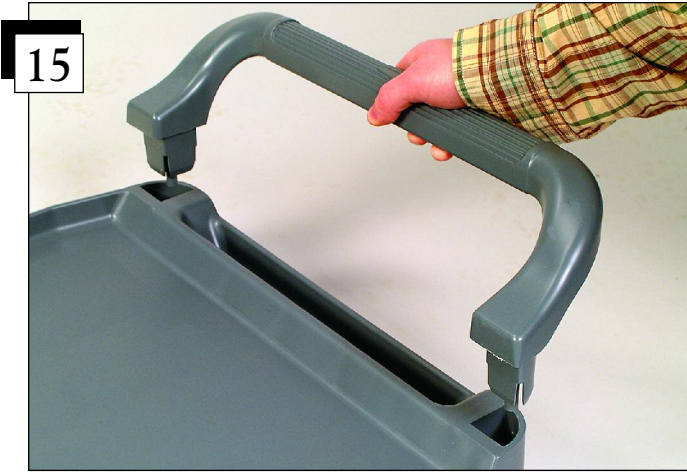

Flip your top shelf over and attach handles to each side.

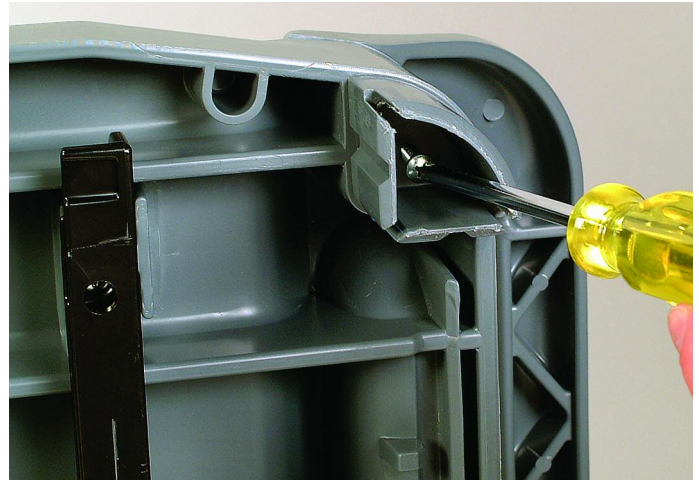

Secure handles by inserting the screws provided into each corner of the shelf. This will keep your handles from detaching during use.



Your top shelf is now ready to be attached.



Position the top shelf so the corners slide into the shelf posts. The shelf ledge should be at the back of the cart.



Tap the shelf into the posts using your rubber mallet.



# ASSEMBLY INSTRUCTIONS FOR THE #5285-01 INSTRUMENT CART

20



Slide your drawer into the black slides on the underside of the top shelf. The drawer may have a slight resistance when sliding until its been used multiple times.

21



Your drawer includes three adjustable dividers. Adjust dividers to the location to meet your needs.

Your cart assembly is now complete.

