

# ASSEMBLY INSTRUCTIONS FOR

## 36" Easy Wall Cabinet with Locking Doors #5097 & 5098

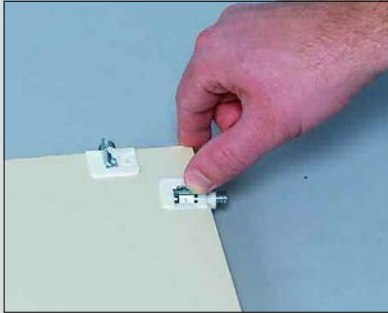

**NOTE:** Fitting toggles on back, top, and bottom panels are shipped in the secure position. Flip the toggles up to unlock before you start assembly.

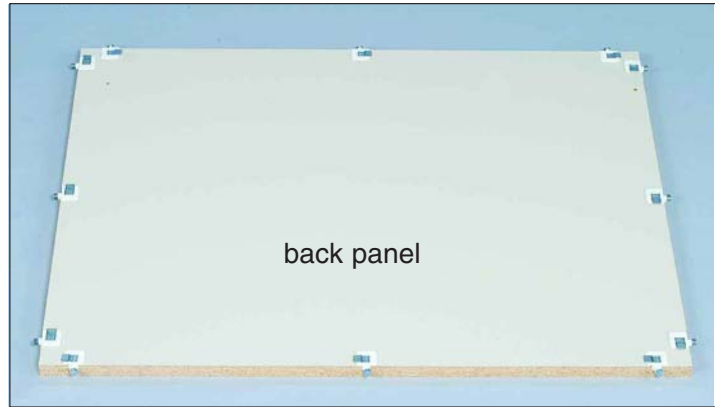

Before assembling your Easy Wall Cabinet, please familiarize yourself with all the parts and check to make sure you have all the parts listed on pages 1 and 2.

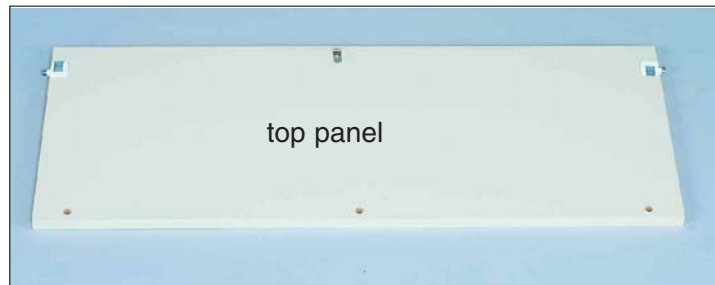

**NOTE:** Be sure to select the appropriate mounting hardware to ensure safe and reliable use. Mount hardware through a stud, blocking or rigid structure where possible during installation.

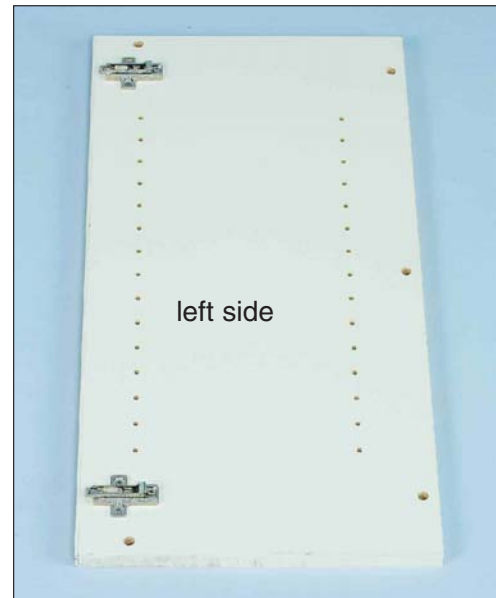
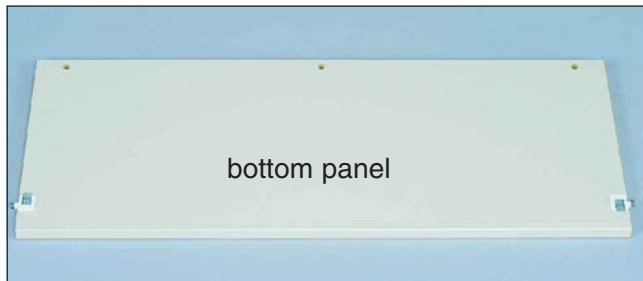

Call Free 1.800.848.1633 or 1.888.HCL-INTL Fax Free 1.800.447.2923  
Website: [www.HealthCareLogistics.com](http://www.HealthCareLogistics.com) • Email: [hcl@HealthCareLogistics.com](mailto:hcl@HealthCareLogistics.com)

# ASSEMBLY INSTRUCTIONS FOR

## 36" Easy Wall Cabinet with Locking Doors #5097 & 5098

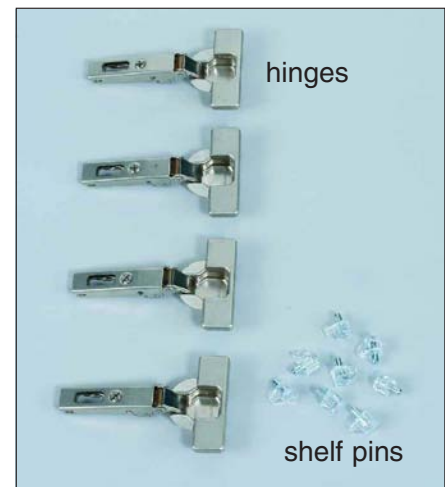
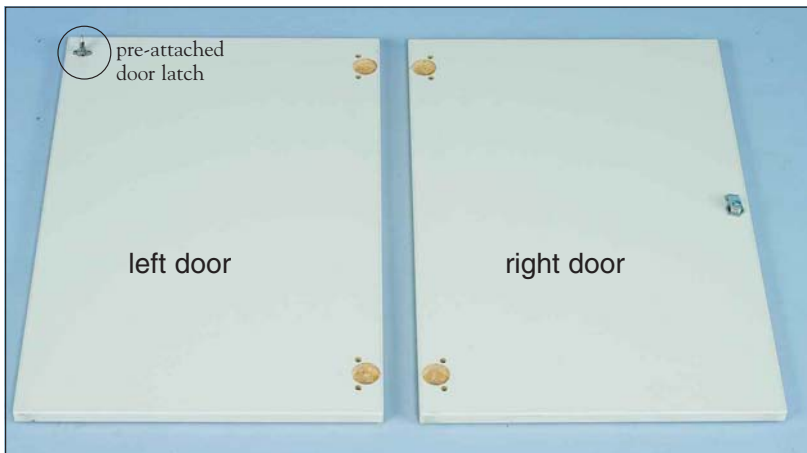
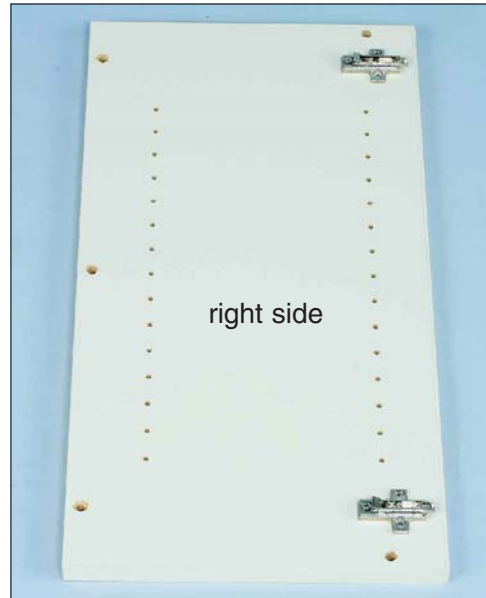
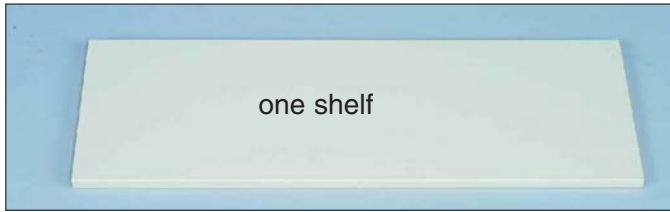

Call Free 1.800.848.1633 or 1.888.HCL-INTL Fax Free 1.800.447.2923  
Website: [www.HealthCareLogistics.com](http://www.HealthCareLogistics.com) • Email: [hcl@HealthCareLogistics.com](mailto:hcl@HealthCareLogistics.com)

# ASSEMBLY INSTRUCTIONS FOR

## 36" Easy Wall Cabinet with Locking Doors #5097 & 5098

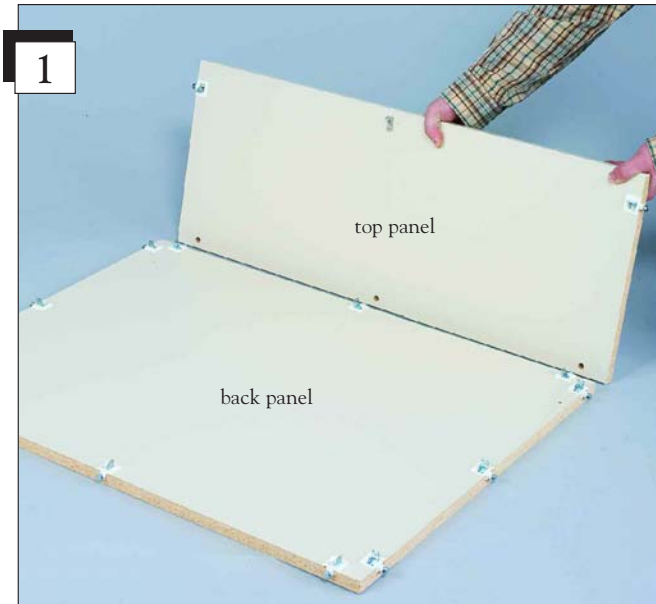

Lay the back panel flat on the floor. Bring the top panel into position.

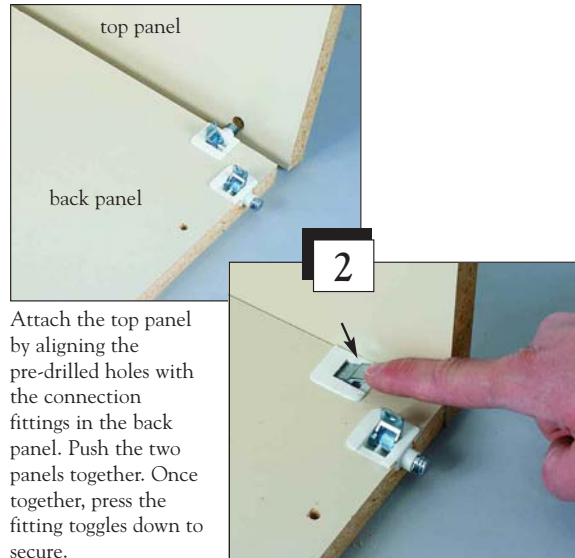

Attach the top panel by aligning the pre-drilled holes with the connection fittings in the back panel. Push the two panels together. Once together, press the fitting toggles down to secure.

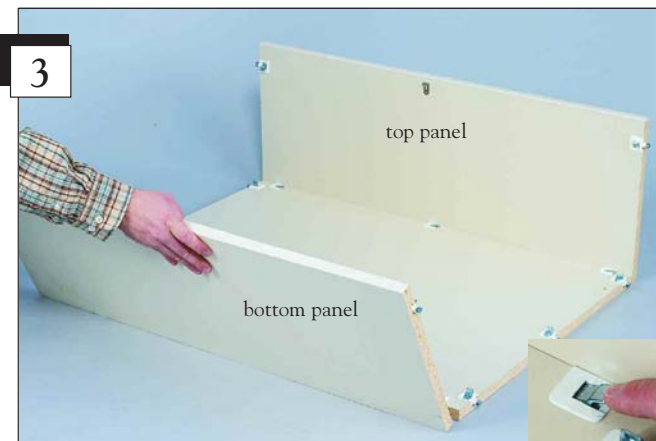

Attach the bottom panel by aligning the pre-drilled holes with the connection fittings in the back panel. Push the two panels together. Once together, press the fitting toggles down to secure.



Your unit will look like this after the top and bottom panels are attached.

Call Free 1.800.848.1633 or 1.888.HCL-INTL Fax Free 1.800.447.2923  
Website: [www.HealthCareLogistics.com](http://www.HealthCareLogistics.com) • Email: [hcl@HealthCareLogistics.com](mailto:hcl@HealthCareLogistics.com)

# ASSEMBLY INSTRUCTIONS FOR

## 36" Easy Wall Cabinet with Locking Doors #5097 & 5098

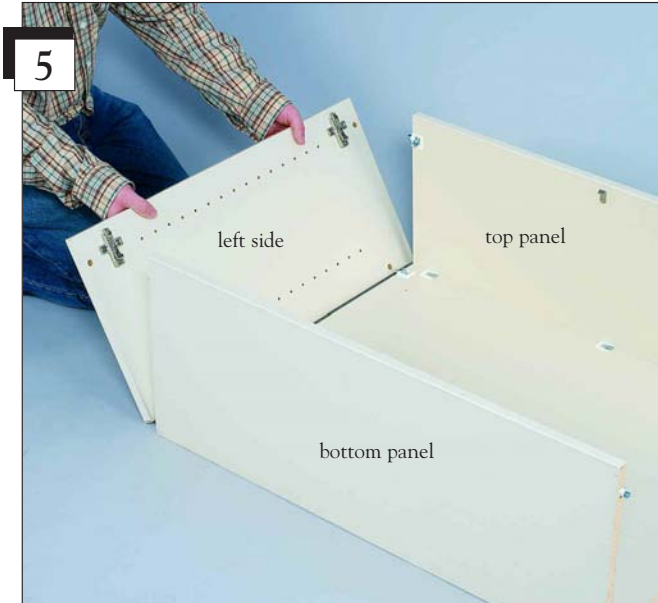

Attach the left side by aligning the pre-drilled holes with the connection fittings in the back, top and bottom panels.



Push the panels together and press the fitting toggles down to secure.

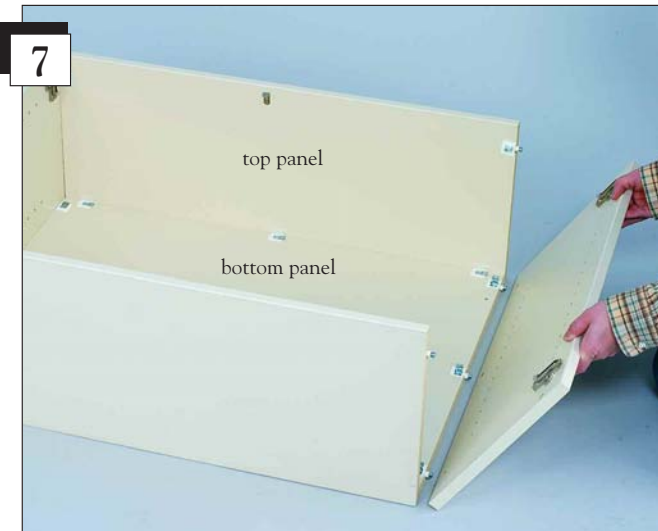

Attach the right side by aligning the pre-drilled holes with the connection fittings in the back, top and bottom panels. Push the panels together and press the fitting toggles down to secure.



Once sides are attached your cabinet unit should look like this. With assistance, raise your unit to the upright position.

Call Free 1.800.848.1633 or 1.888.HCL-INTL Fax Free 1.800.447.2923  
Website: [www.HealthCareLogistics.com](http://www.HealthCareLogistics.com) • Email: [hcl@HealthCareLogistics.com](mailto:hcl@HealthCareLogistics.com)

# ASSEMBLY INSTRUCTIONS FOR

## 36" Easy Wall Cabinet with Locking Doors #5097 & 5098



Decide the positioning of your shelf. The shelf is adjustable in 1/4" (32 mm) increments. Insert the clear plastic shelf pins in the back holes at your desired height. Once the back shelf pins are in place insert shelf pins into the front shelf holes at the same height as the back pins.



Repeat step 9 for the opposite side keeping pins at the same height.



After your shelf pins are in place you're ready to install your shelf. Position shelf onto the shelf pins.



Your shelf is in place and you're ready to attach doors.

Call Free 1.800.848.1633 or 1.888.HCL-INTL Fax Free 1.800.447.2923  
Website: [www.HealthCareLogistics.com](http://www.HealthCareLogistics.com) • Email: [hcl@HealthCareLogistics.com](mailto:hcl@HealthCareLogistics.com)

# ASSEMBLY INSTRUCTIONS FOR

## 36" Easy Wall Cabinet with Locking Doors #5097 & 5098



13

**NOTE:** Latches are shipped with the screw cover plate in the secure position. Before installing latches, the screw cover plate will need released. To release flip the plate up with your fingernail or small screwdriver. The plate is hinged and will lift up.



14

Begin by laying the doors flat on the ground with the hinge hole cutouts (inside of doors) facing up. With screw cover plate lifted, insert pre-assembled hinge screws into the pre-drilled door holes. There are two latches per door.



15

Once hinges are in place and flush against doors, press down on the screw cover plates to secure hinges to doors.

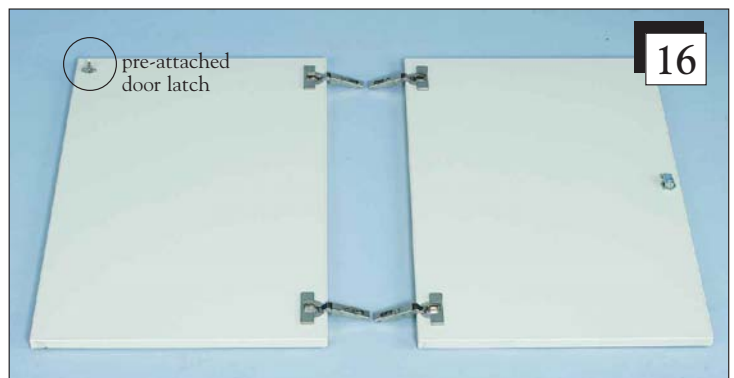

16

Your doors should look like the photo above when hinges are attached.



Call Free 1.800.848.1633 or 1.888.HCL-INTL Fax Free 1.800.447.2923

Website: [www.HealthCareLogistics.com](http://www.HealthCareLogistics.com) • Email: [hcl@HealthCareLogistics.com](mailto:hcl@HealthCareLogistics.com)

# ASSEMBLY INSTRUCTIONS FOR

## 36" Easy Wall Cabinet with Locking Doors #5097 & 5098



Doors are ready to be attached. Position the left door onto the side of the cabinet unit. The hinges should align with pre-installed hinge plates mounted inside of the unit.

**Note:** If you are attaching doors to the 5098 unit with overhang doors it may be easier to lay the unit on its back or set the unit on a desk or counter so that the overhang on the doors does not hit the floor.

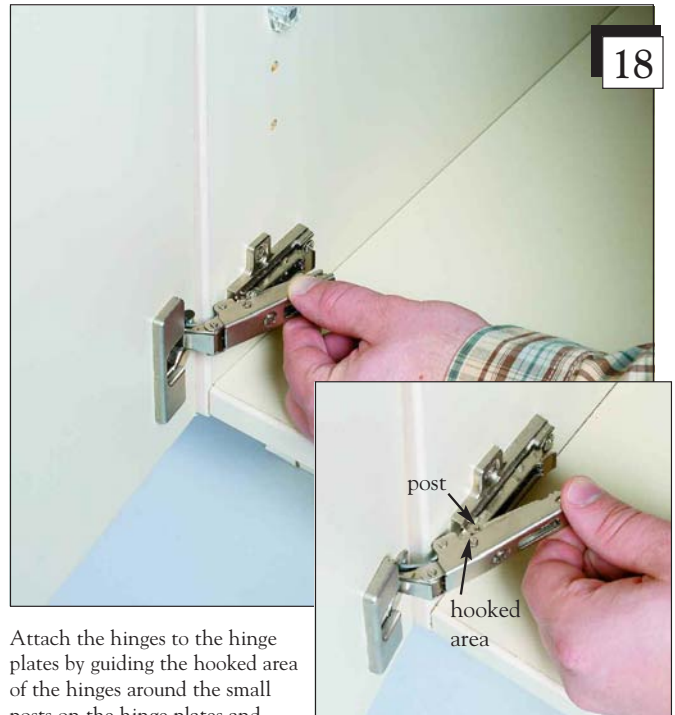

Attach the hinges to the hinge plates by guiding the hooked area of the hinges around the small posts on the hinge plates and pressing them to the plates until they latch.

This step can be tricky and may take a few attempts to get the hinges to latch.



Attach the right door repeating steps 17-18.

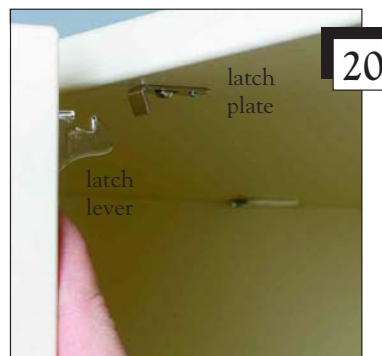

Your cabinet comes with the door latch and latch plate mounted and ready to use. To close the door, squeeze the latch lever and slide the hook under the latch plate. The latch will catch and secure the door.

**Call Free 1.800.848.1633 or 1.888.HCL-INTL Fax Free 1.800.447.2923**  
Website: [www.HealthCareLogistics.com](http://www.HealthCareLogistics.com) • Email: [hcl@HealthCareLogistics.com](mailto:hcl@HealthCareLogistics.com)

# ASSEMBLY INSTRUCTIONS FOR

## 36" Easy Wall Cabinet with Locking Doors #5097 & 5098



Your locking doors are now attached and can be used to secure contents. The cam lock includes two keys. Additional or replacement keys can be purchased through our Resource department.

High quality, fully concealed hinges are self-closing and can be adjusted in three ways to allow you to align your cabinet doors for a consistent look.



**The right adjustment screw provides side adjustment:**  
Side adjustment ... regulates the gaps between doors, cabinets and walls for perfect parallel alignment.

**The middle adjustment screw provides height adjustment:**  
Height adjustment ... lets you align door levels across a row of doors so they match precisely at top and bottom.



**The left adjustment screw provides depth adjustment:**  
Depth adjustment ... lets you bring any style of door into line with the vertical surface of the cabinet.

Your small friend, indeed®  
**Health Care Logistics**  
INC. 

Call Free 1.800.848.1633 or 1.888.HCL-INTL Fax Free 1.800.447.2923  
Website: [www.HealthCareLogistics.com](http://www.HealthCareLogistics.com) • Email: [hcl@HealthCareLogistics.com](mailto:hcl@HealthCareLogistics.com)