

ASSEMBLY INSTRUCTIONS FOR

Bin Holder for Mobile Hygiene Station (#18385 - 18387)

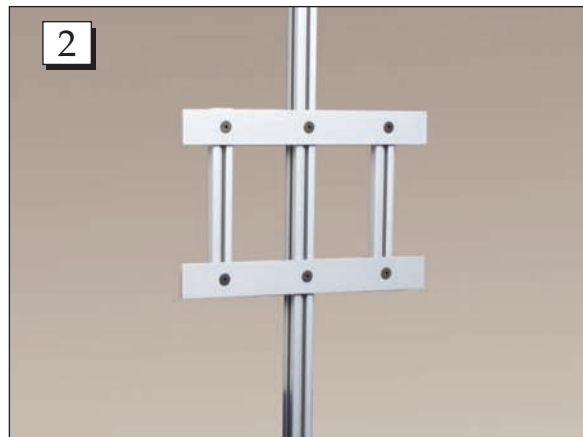

Step 1. Slide the T-Nuts on the bracket onto the pole.



Step 2. Adjust the bracket to the desired height.

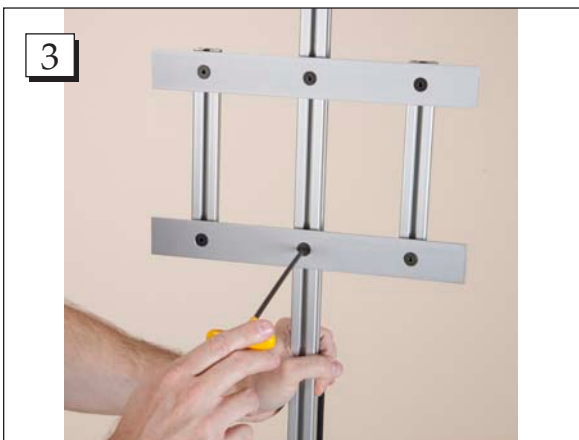

Step 3. Tighten the screws on all of the T-Nuts.



Call Free 1.800.848.1633 • Fax Free 1.800.447.2923
Web: www.HealthCareLogistics.com • Email: hcl@HealthCareLogistics.com