

INSTRUCTIONS FOR

Over the Door Lock Box (#3737)

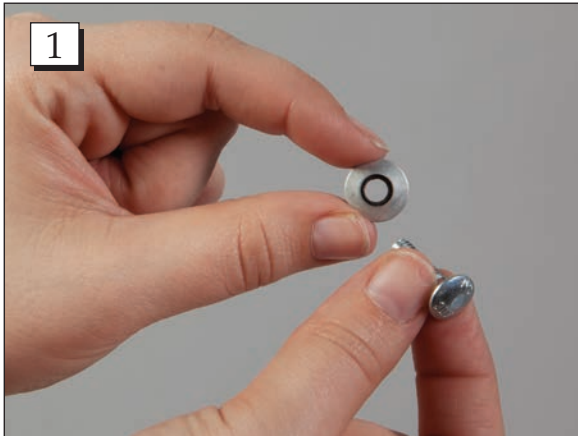

Step 1. Take both bolts and place a washer on the end. Make sure the shiny side of the washer is facing the bolt.



Step 2. Take the hanger and align the holes with the holes in the back of the box. Make sure the hook on the hanger is facing outward.



Step 3. Place the bolt and washer thru the top hole of the hanger and box.



Step 4. Now fasten the bolt in place from the inside of the box with a wing nut. Repeat step 3 and 4 on the bottom hole.



Your Over the Door Lock Box is now ready to be used.

Call Free: 1.800.848.1633 • Fax Free: 1.800.447.2923
Web: GoHCL.com • Email: hcl@GoHCL.com