

INSTRUCTIONS FOR

Wall Mount Flip Table (#19147)

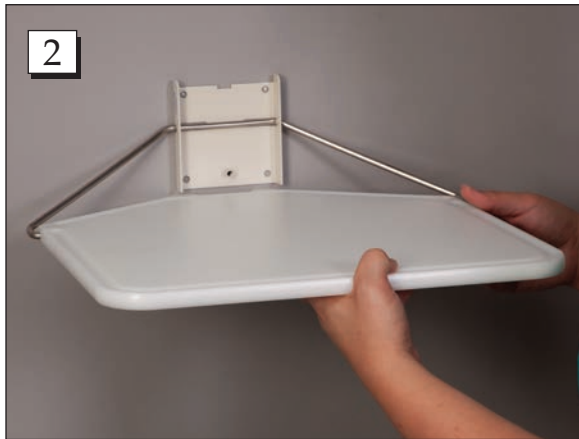

Step 1. Rotate Wall Bracket assembly to remove the cover screw and cover.



Step 2. Place the Wall Bracket to vertical surface.

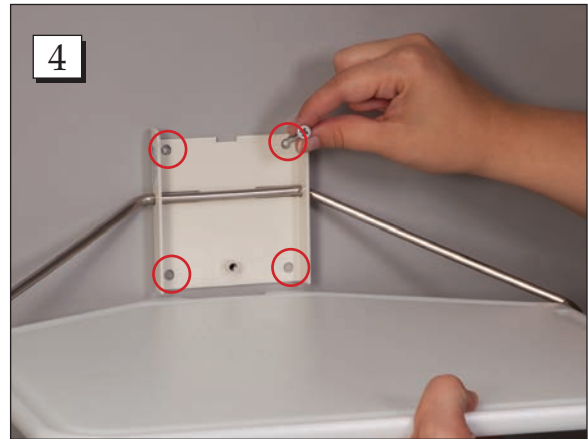

Step 4. Attach with four screws in the indicated corners.

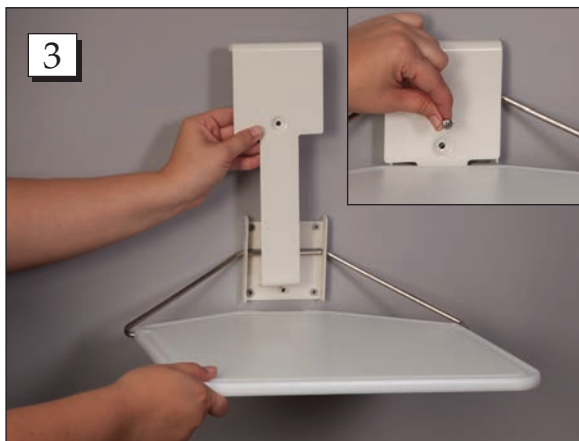

Step 3. Replace cover and screw and your table is installed.



Call Free: 1.800.848.1633 • Fax Free: 1.800.447.2923
Web: GoHCL.com • Email: hcl@GoHCL.com