

ASSEMBLY INSTRUCTIONS FOR

Lock & Locate™ Boxes (#18672 and 18677)



Step 1. Clean surface and peel the protective backing from the Receiving Base.



Step 2. Place the Receiving Base in the Wall Mount or on countertop, cart top or shelves.



Step 3. Press firmly for several seconds to attach the Receiving Base.



Step 4. Loosely drive the screw into the desired location on the wall or cabinet. (Screws are not provided.)

Call Free 1.800.848.1633 • Fax Free 1.800.447.2923
Web: www.GoHCL.com • Email: hcl@GoHCL.com

ASSEMBLY INSTRUCTIONS FOR

Lock & Locate™ Boxes (#18672 and 18677)



Step 5. Place a level on top of the Wall Mount.



Step 6. Once level, tighten screws into the remaining holes.

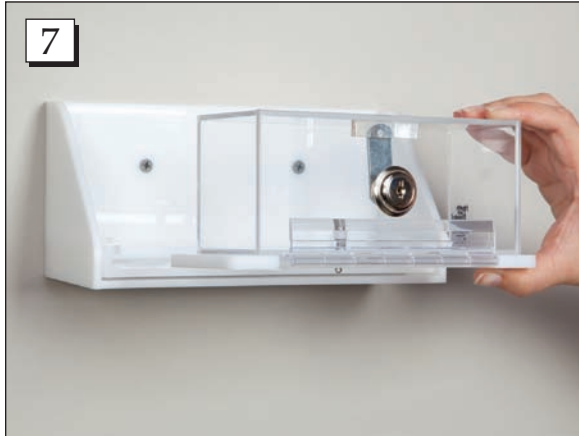

Step 7. Push the locking box onto the Receiving Base. Continue pushing until the locking box clicks into place.



Step 8. Unlock the box.

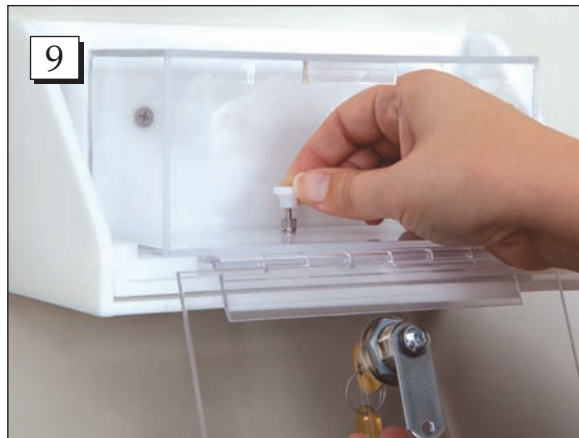

Step 9. Pull up of the white button in the middle of the locking box. While pulling up on the button, pull the entire box forward off of the Receiving Base.



Call Free 1.800.848.1633 • Fax Free 1.800.447.2923
Web: www.GoHCL.com • Email: hcl@GoHCL.com

PROGRAMMING INSTRUCTIONS FOR

Dial Combination Lock

Instructions for setting your personal combination:

- The combination is factory set at >>0-0-0<<
- Combination must be on opening number prior to resetting
- On the underside outer edge of the lock, there is hole for the code reset button. Rotate the face of cam until the code reset button comes into view.
- Push this pin in with a paper clip and keep it pushed in.
- Set your personal combination by turning the dials to the desired combination.
- Release the reset button and your combination is set.
- To lock, rotate lock to “locked” position. Rotate one or more dials after lock is closed. To open the lock, turn dials to your personal combination.

Call Free 1.800.848.1633 • Fax Free 1.800.447.2923

Web: www.HealthCareLogistics.com • Email: hcl@HealthCareLogistics.com

PROGRAMMING INSTRUCTIONS FOR

Dial Combination Lock

Installation Instructions:

- Fits standard 3/4" cam hole
- Short cam can be placed in increments of 90 degree positions
- Long cam can be positioned in increments of 45 degrees

1. Insert lock body through front of 3/4" drilled hole.
2. Wood Only- place prong washer over lock body, prongs facing wood.
3. Thread cylinder nut & tighten.
4. Attached stop cam and straight cam and secure with screw and lock washer.

Note: Stop cam placement



Cam will rotate right



Cam will rotate left

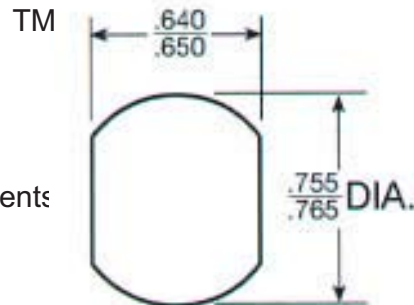

Screw & Lock Washer

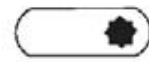

1-1/2" Straight Cam



90° Stop Cam



3/4" Cylinder Nut



1/2" Straight Cam



3/4" Prong Washer

Instructions for setting your personal combination:

- The combination is factory set at >>0-0-0<<
- Combination must be on opening number prior to resetting
- On the underside outer edge of the lock there is hole for the code reset button. Rotate the face of cam until the code reset button comes into view.
- Push this pin in with a paper clip and keep it pushed in.
- Set your personal combination by turning the dials to the desired combination.
- Release the reset button and your combination is set.
- To lock, rotate lock to "locked" position. Rotate one or more dials after lock is closed. To open the lock, turn dials to your personal combination.

Call Free 1.800.848.1633 • Fax Free 1.800.447.2923

Web: www.HealthCareLogistics.com • Email: hcl@HealthCareLogistics.com